

CRAFT PRIZE



Nancy Farrington BA (Hons) Design Crafts
The Maker, Mission Gallery



Mission Gallery, on behalf of the Jane Phillips Award, will award a BA or MA student who has developed a refined body of craft work. The successful student will have their work showcased in The Maker, our dedicated space for emerging talent.

Supported by the Jane Phillips Award.

Administered by Mission Gallery.

In partnership with Swansea College of Art, UWTSD.

JANE
PHILLIPS
AWARD

Mission
Gallery

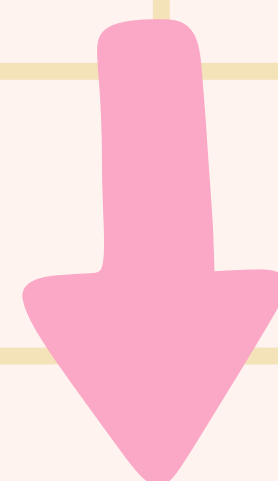

「 SCROLL DOWN
TO LEARN
MORE ABOUT
THE CRAFT
PRIZE 」

Mission will visit the end of year shows and make a recommendation to Swansea College of Art UWTSD colleagues as to the selected student.

Selection will be made from students graduating from Design Crafts, Surface Pattern Design.

Key selection criteria:

- Originality of concept
- Application of idea(s)
- Making skills
- Integrity of finished pieces of work

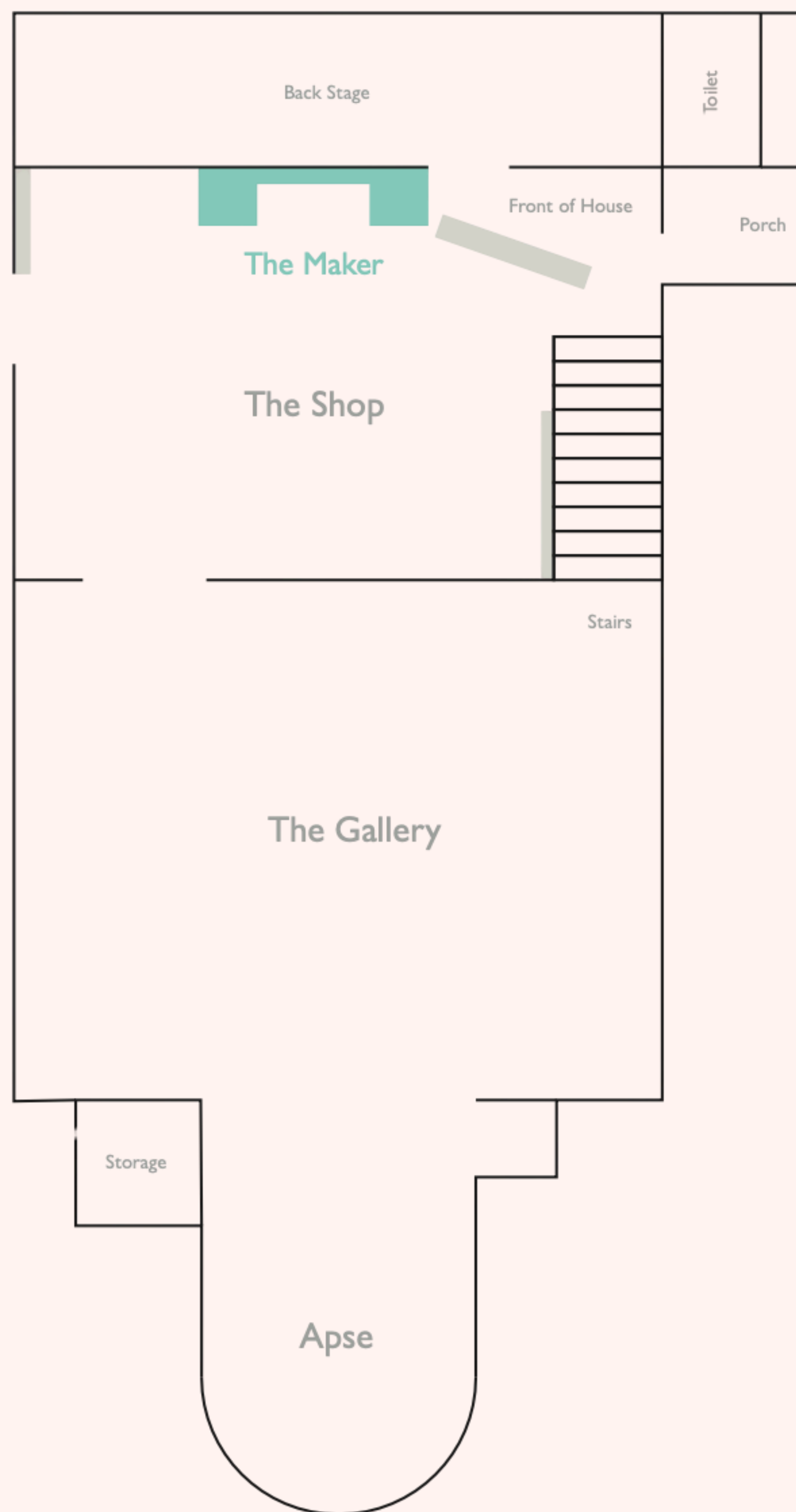

**JANE
PHILLIPS
AWARD**

Mission
Gallery

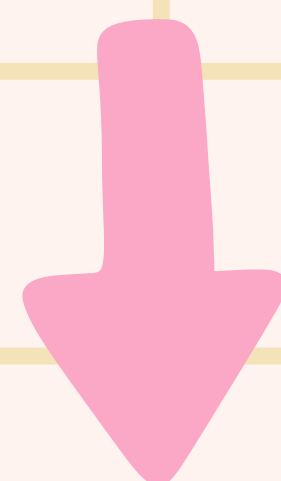

「SCROLL DOWN
TO LEARN
ABOUT THE
JANE PHILLIPS
AWARD」

ABOUT THE JANE PHILLIPS AWARD

Launched at Mission Gallery in 2011, the Jane Phillips Award is a memorial to Jane Phillips (1957-2011) Mission Gallery's first director. The award is intended as a legacy to Jane's passion for mentoring and nurturing talent, working with individuals at every level - offering opportunities to students as well as artists at the beginning of their journey.

For more information about the Jane Phillips Award, visit

Q WWW.JANEPHILLIPSAWARD.COM X



Eve Slatter, 2024 digital residency

JANE PHILLIPS AWARD

Mission
Gallery